

RP25283 INSTALLATION INSTRUCTIONS

DRAG LINK REPAIR KIT

CAUTION: This kit must be installed by a qualified mechanic, otherwise an unsafe vehicle and/or personal injury could result.

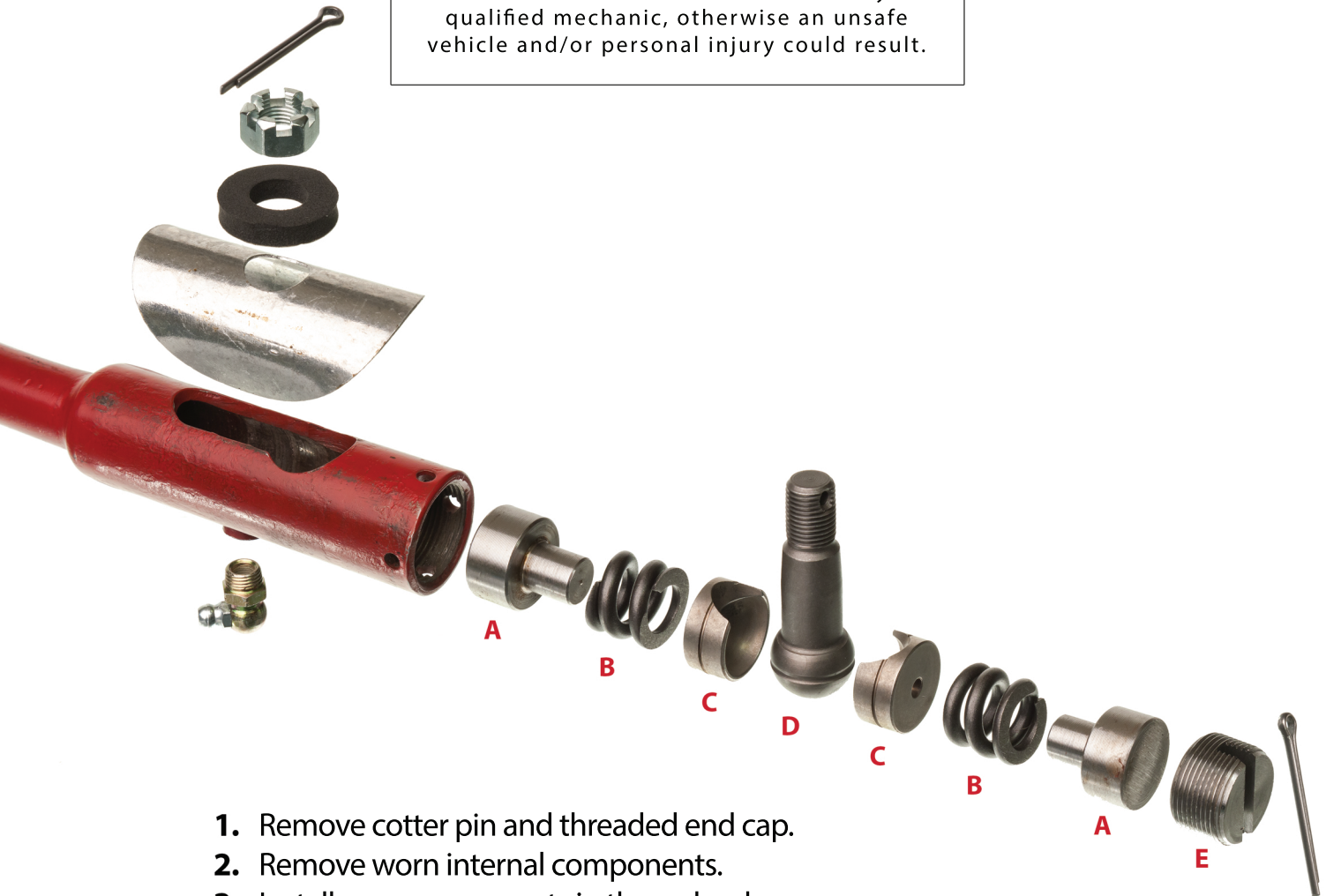

1. Remove cotter pin and threaded end cap.
2. Remove worn internal components.
3. Install new components in the order shown.
4. pregrease each component as you install - especially the stud ball (D) and bal cups (C).
5. Tighten threaded end cap (E) until it bottoms out, and back off to the nearest cotter pin hole
6. Lubricate with a high quality grease, such as AMSOIL.
7. Reinstall drag link.

RARE
PARTS®
INC.
STEERING AND SUSPENSION
DIAMOND SERIES