

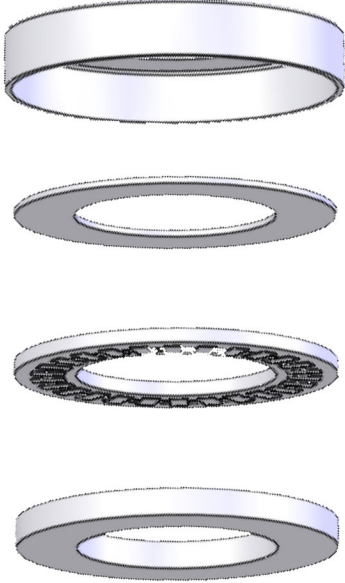

Bearing Assembly Instructions

TOP



Pack Dust Caps, Thrust Washers, & Needle Bearings with good quality grease.

Install with closed side of cap facing up as shown

RP Form# 20923



Bearing Assembly Instructions

TOP

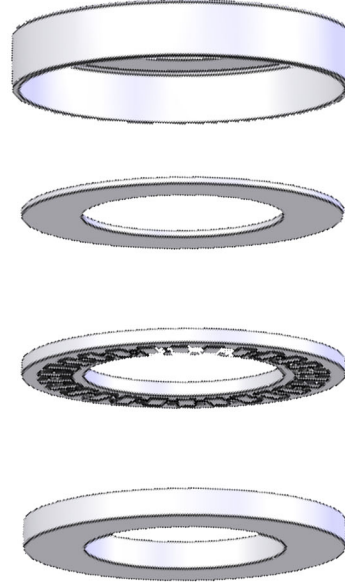

Pack Dust Caps, Thrust Washers, & Needle Bearings with good quality grease.

Install with closed side of cap facing up as shown

RP Form# 20923



Bearing Assembly Instructions

TOP

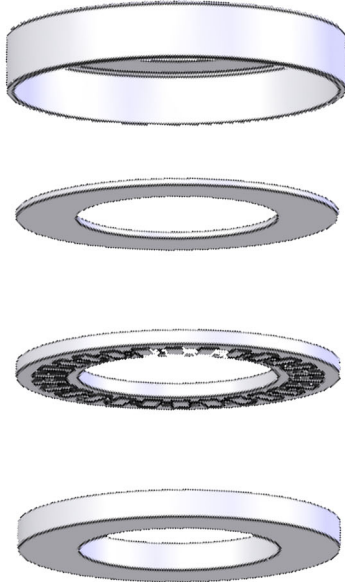

Pack Dust Caps, Thrust Washers, & Needle Bearings with good quality grease.

Install with closed side of cap facing up as shown

RP Form# 20923



Bearing Assembly Instructions

TOP

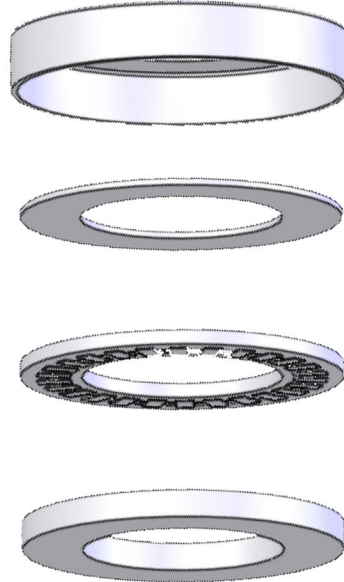

Pack Dust Caps, Thrust Washers, & Needle Bearings with good quality grease.

Install with closed side of cap facing up as shown

RP Form# 20923